

CONSTRUCTION PLANS

FOR

AMES STREET

STREETSCAPE LIGHTING

VILLAGE OF ELK RAPIDS, ANTRIM COUNTY, MICHIGAN

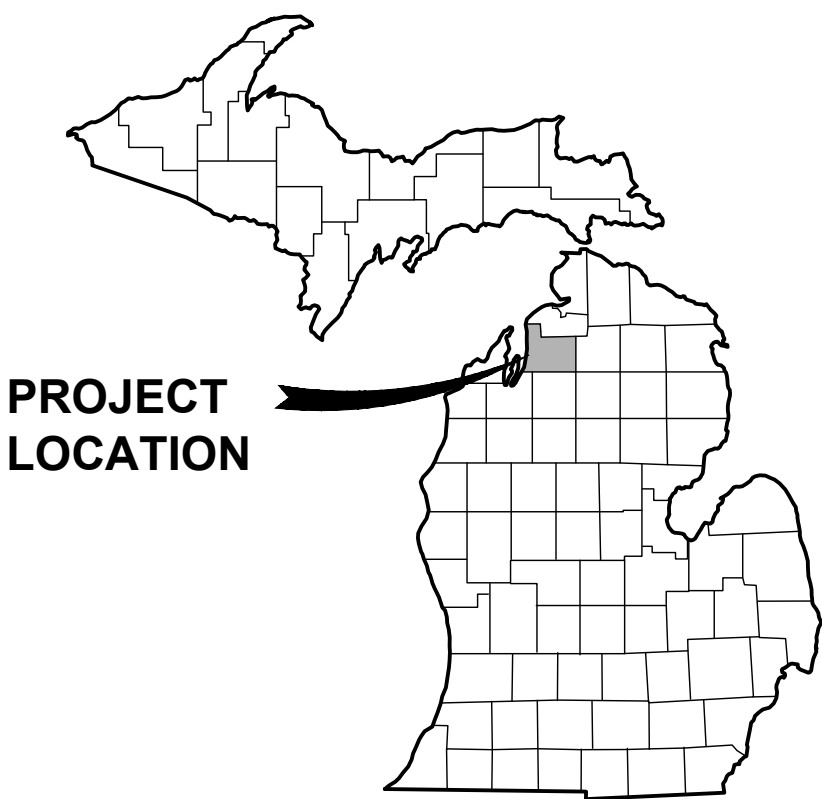

VICINITY MAP
SCALE: N.T.S.

OWNER

VILLAGE OF ELK RAPIDS
315 BRIDE ST.
P.O. BOX 398
ELK RAPIDS, MI 49629
CONTACT: JOHN MATTHEWS, VILLAGE MANAGER
PH: 231.264.9274

ENGINEER

GOSLING CZUBAK ENGINEERING SCIENCES, INC.
1280 BUSINESS PARK DRIVE
TRAVERSE CITY, MICHIGAN, 49686-8607
231.946.9191 - 800.968.1062
www.goslingczubak.com info@goslingczubak.com

UTILITY CONTACTS

NAME OF OWNER	TYPE OF UTILITY
DTE ENERGY 1294 NORTH US 31 PETOSKEY, MI 49770 231.258.3785	GAS DISTRIBUTION
CONSUMER'S ENERGY 821 HASTINGS TRAVERSE CITY, MI 49686 231.929.6244 CONTACT: BLAINE SHOTWELL, PE	ELECTRIC
CHARTER COMMUNICATIONS 701 S. AIRPORT RD. TRAVERSE CITY, MI 49686 231.929.7012 EXT. 102	CABLE TV
AT&T 142 E. STATE ST. TRAVERSE CITY, MI 49684 231.941.2707	TELEPHONE
VILLAGE OF ELK RAPIDS 315 BRIDE ST. P.O. BOX 398 ELK RAPIDS, MI 49629 231.264.9971 CONTACT: ALEX PRAY	SEWER & WATER

EXISTING UTILITIES

THE EXISTING UTILITIES LISTED ABOVE AND SHOWN ON THESE PLANS REPRESENT THE BEST INFORMATION AVAILABLE. THIS INFORMATION DOES NOT RELIEVE THE CONTRACTOR OF THE RESPONSIBILITY TO BE SATISFIED AS TO THE ACCURACY AND THE LOCATION OF EXISTING UTILITIES. THE CONTRACTOR SHALL NOTIFY "MISS DIG" (1-800-482-7171) THREE WORKING DAYS PRIOR TO THE START OF CONSTRUCTION.



Know what's below.
Call before you dig.

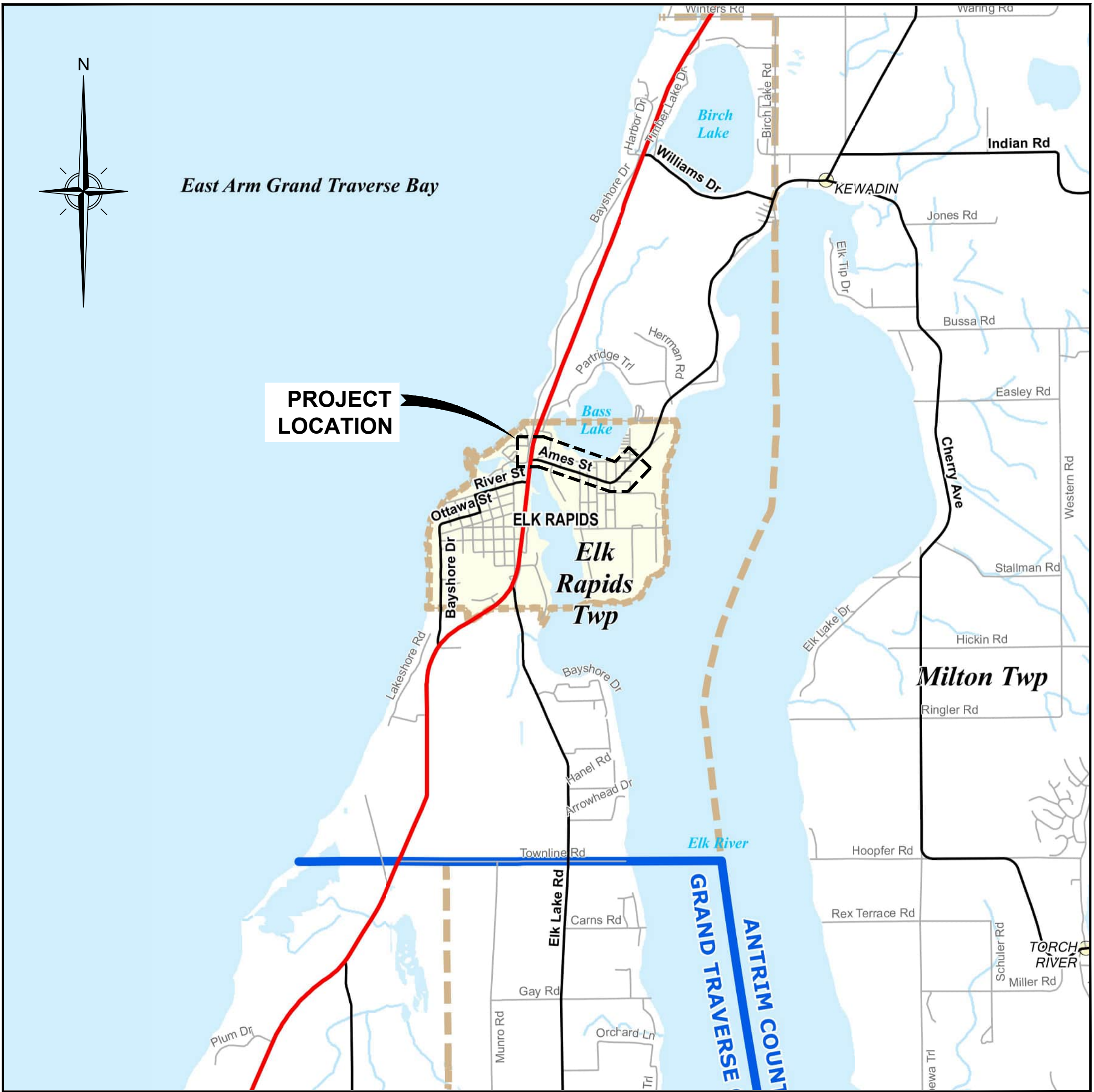

LOCATION MAP
NOT TO SCALE

Sheet List Table	
Sheet Number	Sheet Title
C1	COVER
O1	OVERALL PROJECT LAYOUT
S1	PROPOSED LIGHTING PLAN - LAYOUT 1 & 2
S2	PROPOSED LIGHTING PLAN - LAYOUT 3 & 4
S3	PROPOSED LIGHTING PLAN - LAYOUT 5 & 6
S4	PROPOSED LIGHTING PLAN - LAYOUT 7 & 8
S5	PROJECT DETAILS



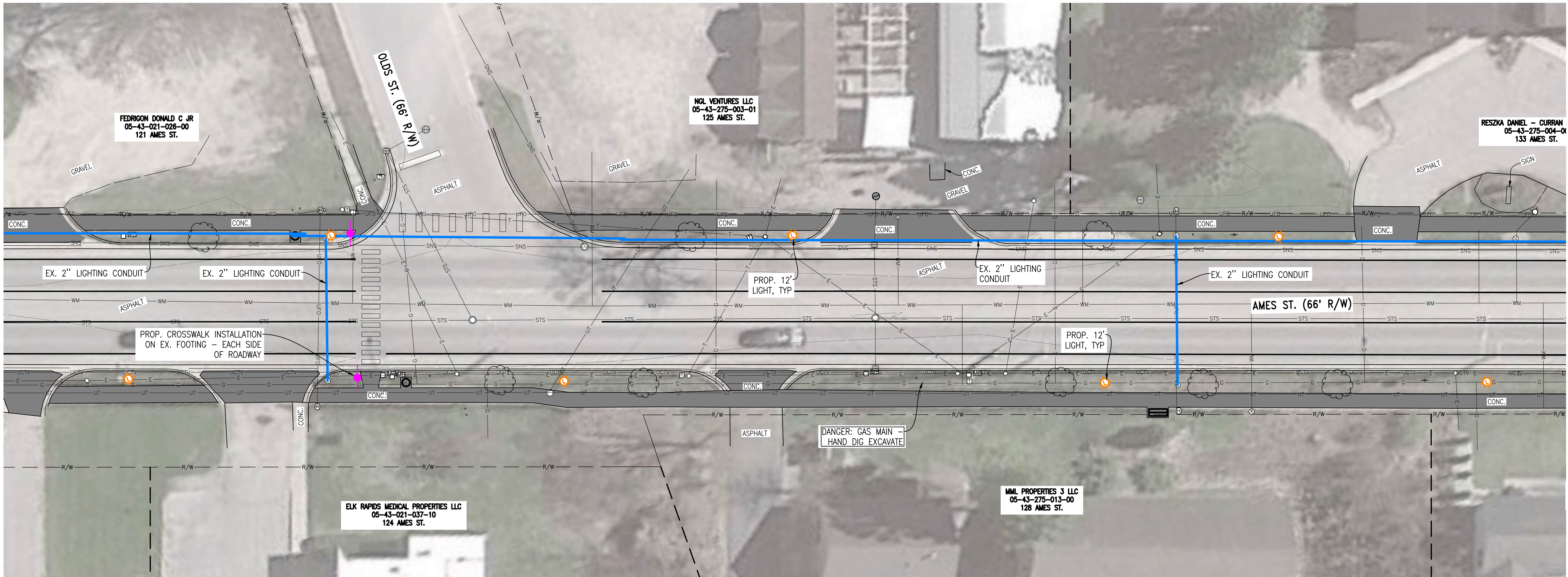

PROPOSED STREETSCAPE LIGHTING PLAN - LAYOUT 3
SCALE: 1" = 20'

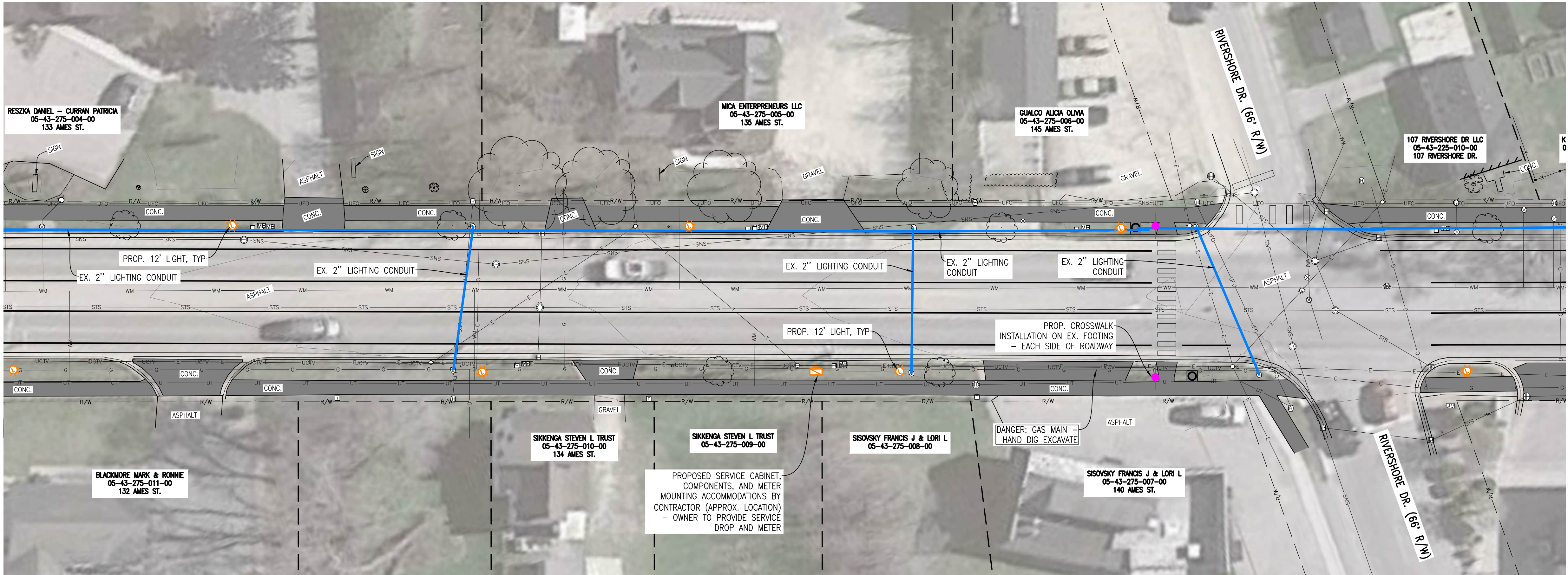

PROPOSED STREETSCAPE LIGHTING PLAN - LAYOUT 4
SCALE: 1" = 20'

PROPOSED
LIGHTING LEGEND

- PROPOSED 12' LIGHT AND POLE BASE
- PROPOSED 20' LIGHT AND POLE BASE (ALTERNATE)
- PROPOSED CROSSWALK SIGN INSTALL ON EXISTING FOUNDATION
- EXISTING 2" ELECTRICAL LIGHTING CONDUIT

EXISTING LEGEND

- EXISTING CABLE TV PEDESTAL
- EXISTING CLEAN OUT
- EXISTING UTILITY POLE
- EXISTING FIBER HAND HOLE
- EXISTING ELECTRIC HAND HOLE
- EXISTING MANHOLE (AS NOTED)
- EXISTING ELECTRIC METER
- EXISTING ELECTRIC PEDESTAL
- EXISTING ELECTRIC TRANSFORMER
- EXISTING GUY ANCHOR
- EXISTING TELEPHONE PEDESTAL
- EXISTING GAS METER
- EXISTING GAS VALVE
- EXISTING CATCH BASIN - ROUND
- EXISTING CATCH BASIN - SQUARE
- EXISTING MAIL BOX
- EXISTING SIGN
- EXISTING UNDERGROUND MARKER
- EXISTING CURB STOP BOX
- EXISTING FIRE HYDRANT
- EXISTING BUILDING
- EXISTING ROAD RIGHT-OF-WAY
- EXISTING FENCE
- EXISTING WATER SERVICE
- EXISTING STORM SEWER
- EXISTING SANITARY SEWER
- EXISTING GAS
- EXISTING ELECTRIC - OVERHEAD
- EXISTING FIBER - UNDERGROUND
- EXISTING CABLE - UNDERGROUND
- EXISTING TELEPHONE - UNDERGROUND
- EXISTING TELEPHONE - OVERHEAD
- EXISTING CONCRETE
- EXISTING DECIDUOUS/EVERGREEN TREE

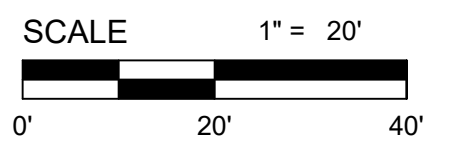
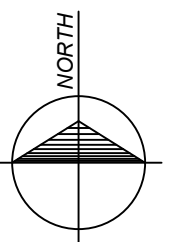

GoslingCzubak
engineering sciences, inc.
1280 Business Park Drive
Traverse City, Michigan
231-946-9191 phone
info@goslingczubak.com
www.goslingczubak.com

ENGINEERS • SURVEYORS
LANDSCAPE ARCHITECTS
ENVIRONMENTAL & DRILLING
CONSTRUCTION MATERIALS TESTING

PROPOSED LIGHTING PLAN - LAYOUT 3 & 4
AMES ST. STREETSCAPE LIGHTING
VILLAGE OF ELK RAPIDS

Date Issued:	12/23/25
Date Surveyed:	DEC. 2025
Designed By:	KSK
Drawn By:	KSK
Checked By:	MJH
Scale:	AS NOTED
Original sheet size is 22x34	
Location:	SECTION 21 T29N, R9W ANTRIM COUNTY MICHIGAN
Project Number:	250457
Sheet:	S2

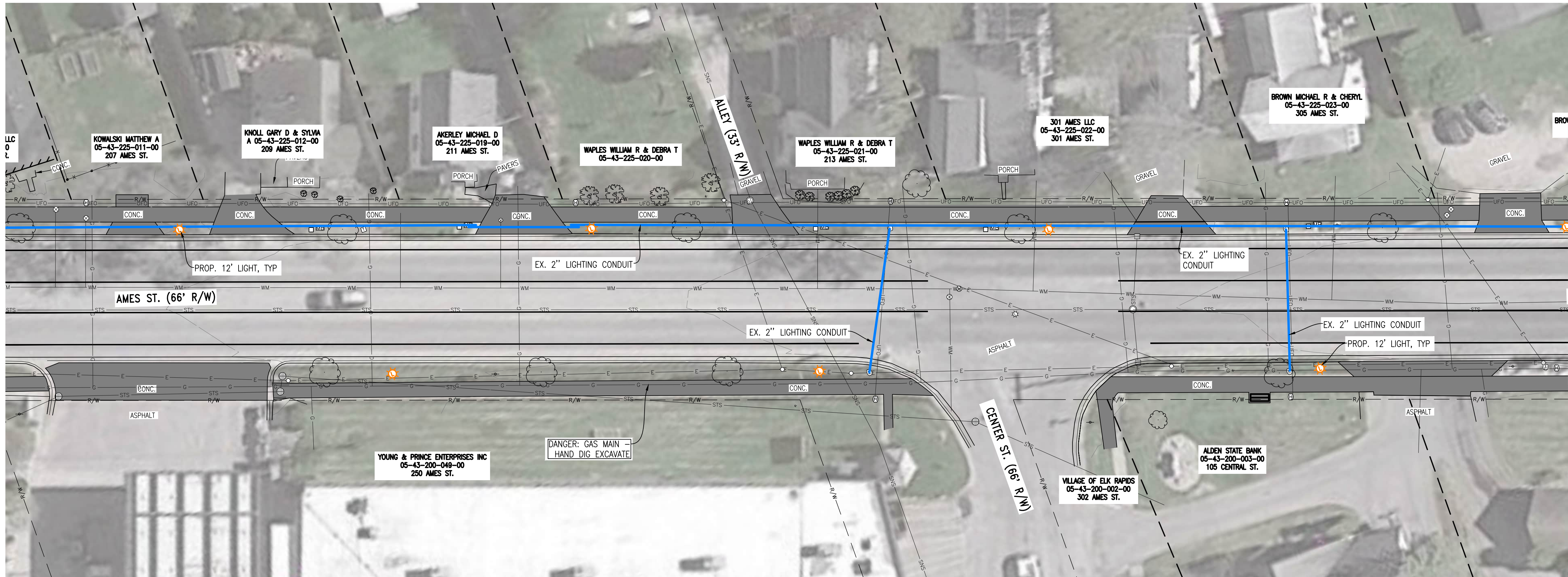

PROPOSED STREETSCAPE LIGHTING PLAN - LAYOUT 5
SCALE: 1" = 20'

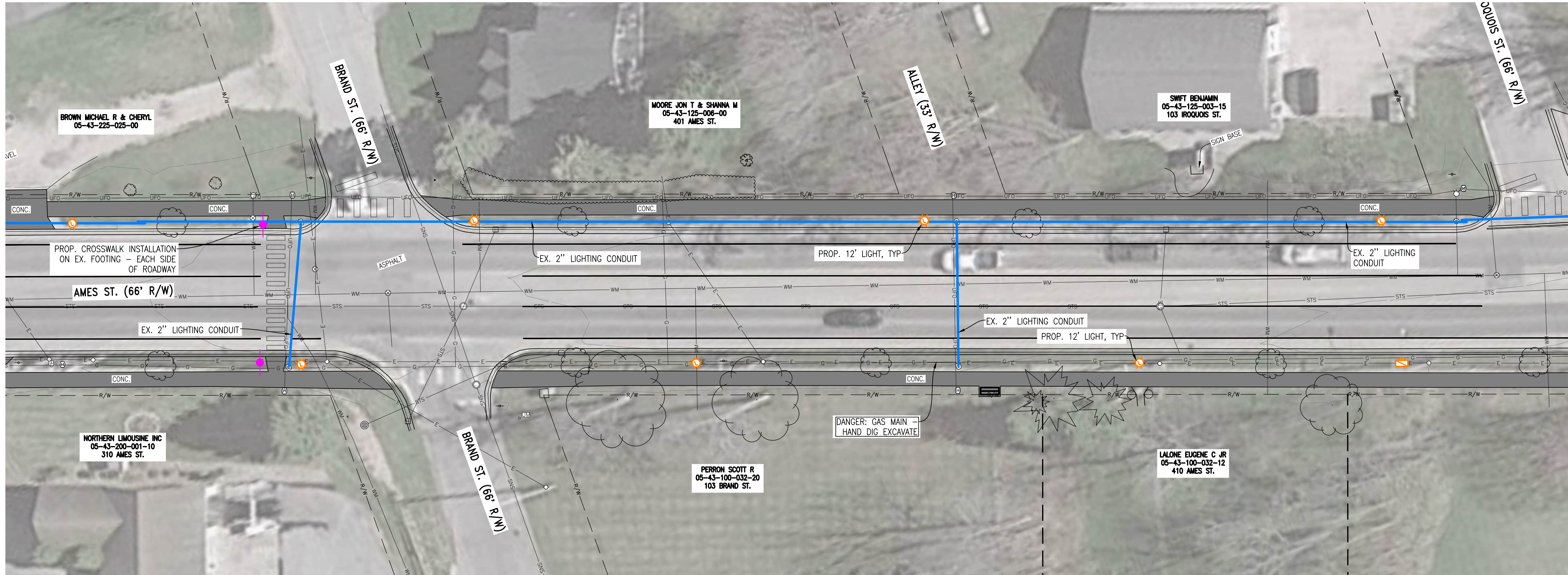

PROPOSED STREETSCAPE LIGHTING PLAN - LAYOUT 6
SCALE: 1" = 20'

PROPOSED
LIGHTING LEGEND

- PROPOSED 12' LIGHT AND POLE BASE
- PROPOSED 20' LIGHT AND POLE BASE (ALTERNATE)
- PROPOSED CROSSWALK SIGN INSTALL ON EXISTING FOUNDATION
- EXISTING 2" ELECTRICAL LIGHTING CONDUIT

EXISTING LEGEND

- EXISTING CABLE TV PEDESTAL
- EXISTING CLEAN OUT
- EXISTING UTILITY POLE
- EXISTING FIBER HAND HOLE
- EXISTING ELECTRIC HAND HOLE
- EXISTING MANHOLE (AS NOTED)
- EXISTING ELECTRIC METER
- EXISTING ELECTRIC PEDESTAL
- EXISTING ELECTRIC TRANSFORMER
- EXISTING GUY ANCHOR
- EXISTING TELEPHONE PEDESTAL
- EXISTING GAS METER
- EXISTING GAS VALVE
- EXISTING CATCH BASIN - ROUND
- EXISTING CATCH BASIN - SQUARE
- EXISTING MAIL BOX
- EXISTING SIGN
- EXISTING UNDERGROUND MARKER
- EXISTING CURB STOP BOX
- EXISTING FIRE HYDRANT
- EXISTING BUILDING
- EXISTING ROAD RIGHT-OF-WAY
- EXISTING FENCE
- EXISTING WATER SERVICE
- EXISTING STORM SEWER
- EXISTING SANITARY SEWER
- EXISTING GAS
- EXISTING ELECTRIC - OVERHEAD
- EXISTING FIBER - UNDERGROUND
- EXISTING CABLE - UNDERGROUND
- EXISTING TELEPHONE - UNDERGROUND
- EXISTING TELEPHONE - OVERHEAD
- EXISTING CONCRETE
- EXISTING DECIDUOUS/EVERGREEN TREE

PROPOSED LIGHTING PLAN - LAYOUT 5 & 6
AMES ST. STREETSCAPE LIGHTING
VILLAGE OF ELK RAPIDS

Date Issued: 12/23/25
Date Surveyed: DEC. 2025
Designed By: KSK
Drawn By: KSK
Checked By: MJH
Scale: AS NOTED
Original sheet size is 22x34

Location:
SECTION 21
T29N, R34W
ANTRIM COUNTY
MICHIGAN

Project Number:
250457

Sheet:

S3

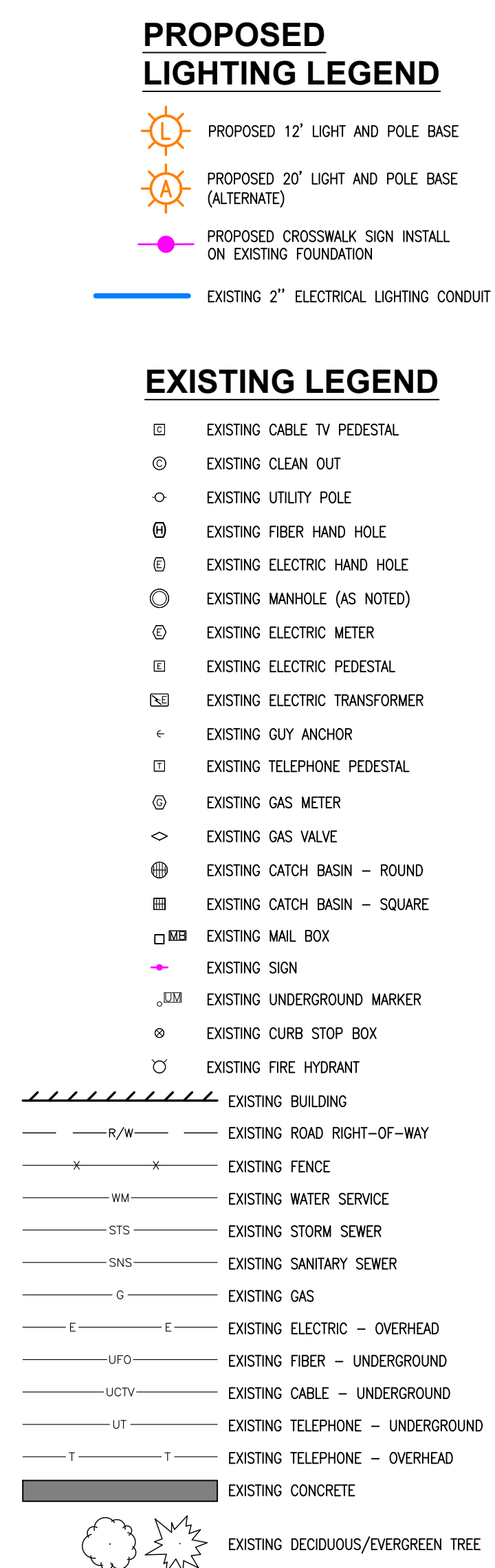



Gosling Czubak
engineering sciences, inc.

**1280 Business Park Drive
Traverse City, Michigan
231-946-9191 phone
info@goslingczubak.com
www.goslingczubak.com**

**ENGINEERS • SURVEYORS
LANDSCAPE ARCHITECTS
ENVIRONMENTAL & DRILLING
CONSTRUCTION MATERIALS TESTING**

Date Issued:	12/23/25
Date Surveyed:	DEC. 2025
Designed By:	KSK
Drawn By:	KSK
Checked By:	MJH
Scale:	AS NOTED
Original sheet size is 22x34	
Location:	
SECTION 21	
T29N, R9W	
ANTRIM COUNTY	
MICHIGAN	
====	
Project Number:	250457
Sheet:	S4



**Know what's below.
Call before you dig.**

THE LOCATION OF THE EXISTING UTILITIES, AS SHOWN ON THIS PLAN, APPROXIMATE ONLY. IT SHALL BE THE RESPONSIBILITY OF THE CONTRACTOR TO VERIFY ACTUAL LOCATION AND DEPTH OF ALL EXISTING UTILITIES. THE OWNER AND THE SURVEYOR SHALL NOT BE RESPONSIBLE FOR ANY OMISSION OR VARIATION FROM THE LOCATION SHOWN. THE CONTRACTOR SHALL NOTIFY "MISS DIG" AT 1 (800) 482-7171 OR THREE (3) WORKING DAYS PRIOR TO THE START OF CONSTRUCTION.

[illegible]

PROJECT DETAILS
JAMES ST. STREETSCAPE LIGHTING
VILLAGE OF ELK RAPIDS

Date Issued: 12/23/2023
Date Surveyed: DEC. 2023
Designed By: KSH
Drawn By: KSH
Checked By: MJH
Scale: AS NOTED

Location: SECTION 21
T29N, R9W
ANTRIM COUNTY
MICHIGAN

Project Number: 250457

Sheet:

S5